



# **Wiedemann**

**Universal turf maintenance machine**

*Sweeping*

*Verticutting*

*Flail-type mowing*

*High dump feature*



## ***SUPER 500***

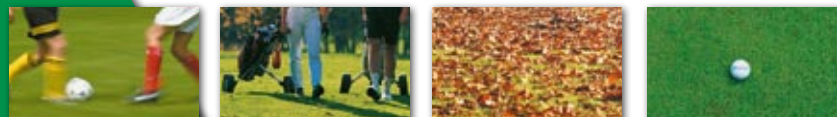

# ***SUPER 500: the new standard in turf maintenance***

The **SUPER 500** is compact, rugged, and multi-talented. Park grounds, recreational areas, extensively maintained areas, ecological meadows, athletic fields, and golf courses are its "home turf". Whether it's sweeping, verticutting, mowing, or collecting grass and leaves, you will be impressed by the **SUPER 500** from the first cut in spring until fall.

The **SUPER 500** delivers excellent quality of work. The parallelogram-guided sweeper head ensures that implements maintain an optimal working position at all times. This is a great advantage on undulating surfaces. You can select between the brush-type and the multi-purpose sweeper head. Your choice of sweeper head depends on your requirements.

The multi-purpose sweeper head is equipped as standard with an additional center-mounted roller to prevent scalping on uneven turf.

The multi-purpose sweeper head can be equipped with various implements for a variety of applications.

The implements are manufactured from wear-resistant special grade steel and mounted in pendulum fashion. This ensures excellent work results over the full working width. For verticutting work, you can choose between cutting blade spacings of ¾", 1½" or 2¼".

Implement changing is simple and can be done without tools.





**Sweeping / collecting leaves**  
Collecting grass clippings or leaves without damage to turf by means of brush-type head or multi-purpose sweeper head.



**Verticutting**  
Verticutting with simultaneous collecting of material. Verticutting spacing ¾", 1½" or 2¼"

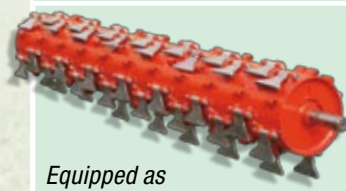

**The SUPER 500 can be equipped with two different sweeper heads:**

<b>Brush-type sweeper head</b>	<b>Implement</b>	<b>Application</b>
	Brush-type cylinder	Sweeping and collecting grass clippings, leaves, and debris.
<b>Multi-purpose sweeper head</b>	<b>Implement</b>	<b>Application</b>
 <i>Equipped as standard with wind paddle</i>	Hard metal verticutting blade with wind paddle 	Verticutting in dry and wet conditions. Collecting grass clippings, leaves, and debris.
	Flail blade 	Flail-type mowing and collecting grass clippings, leaves, and debris in dry and wet conditions.





**Flail-type mowing**

Mowing and collecting in a single operation. For fast and cost-effective maintenance of ecological meadows, golf courses, park grounds, etc.

**High dump feature**

The parallelogram-guided high dump feature enables dumping from any lifting height.

■ The air flow path



■ **The sophisticated working concept**

The material is collected by the implements and transported into the container by a powerful air flow. The air flow path ensures complete filling of the container. The dust-laden air stream leaves the container through clearly defined air outlets and is blown downwards directly onto the surface through a special cover flap. This reduces dust emission into the air, which benefits both the driver and the environment.

■ **The high dump feature**

The high dump feature allows the container to be discharged in any desired lifting height up to a max. of 83". This provides significant time savings since, where low overhead loading heights are required, the container does not initially have to be lifted to highest position to be emptied.

■ **The tires**

Special attention was paid to the use of tires with a large contact area and low ground pressure to protect the turf. You can choose between two wide turf tires or 4 low pressure tires with floating axle, depending on your requirements.

The combination of four turf tires and floating axle is particularly ideal on undulating ground as the floating axle always maintains an even load distribution to the four wheels.

■ **The golf course kit**

The SUPER 500 can be equipped with the optional golf course kit, specially designed for use on heavily undulating terrain. The golf course kit consists of a front steel roller and two additional lateral anti-scalp rollers which reliably prevent scalping.

■ **The drive**

The parallelogram-guided sweeper head is driven by a double V-belt (brush-type sweeper head) or ribbed V-belt (multi-purpose sweeper head).

■ **Ease of operation**

The hydraulic operating unit of the SUPER 500 is easy to access from the tractor seat. The SUPER 500 can be operated even more conveniently with the optional electromagnetic remote control.

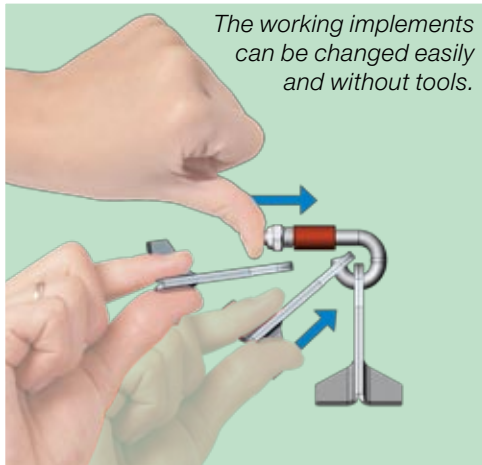

The working implements can be changed easily and without tools.



## The demands on a multitalent

- Year-round, cost-efficient, and effective use of the machine.
- Parallelogram-guided sweeper head.
- Easy operation of the control elements from the tractor's seat.
- Long service life thanks to robust quality and excellent processing of all materials.
- Easy and safe access to all components for cleaning and maintenance work.
- Easy, fast, and tool-less implement changing.
- Parallelogram-guided high dump feature.
- Machine is manufactured for better turn maneuvering (prevents the machine from swivelling).
- Excellent adaptation to undulating terrain.
- High level of operational safety through TÜV approved safety equipment.



TECHNICAL DATA	SUPER 500	SUPER 500
Model:	Brush-type sweeper head	Multi-purpose sweeper head
Function:	Parallelogram-guided brush-type sweeper head	Parallelogram-guided multi-purpose sweeper head
Sweeping:	Yes	Yes
Verticutting:	No	Yes (spacing ¾" 1½" or 2¼")
Flail-type mowing:	No	Yes
Anti-scalp roller:	centered, height adjustable	Centered, height adjustable
Implement change:	-	Yes (no tools required)
Working width in inches:	63"	63"
Volume capacity in cubic yards:	3.3	3.3
Dumping (hydraulic):	High dumping (up to 83")	High dumping (up to 83")
Adjustment of working height:	Slotted spacer rings (adjustment range 5.9")	
Drawbar:	Low hitch	
Drive:	PTO shaft 540 RPM	PTO shaft 540 RPM
Minimum engine power requirement to tractor:	25 HP	35 HP
Working cylinders (drive):	Double V-belt, autom. tensioning	Ribbed V-belt (10PL), autom. tensioning
Axle:	Rigid axle	Floating axle
Front tires:	2 x (11 x 4.00-5)	2 x (11 x 7-4)
Rear tires:	Rigid axle, 2 x (23 x 10.50)	floating axle, 4 x (18 x 8.50)
Machine length in inches:	124"	124"
Machine width in inches:	76"	81"
Machine height in inches:	70"	70"
Tare weight in lbs. (approx.):	1983	2381
Max. perm. gross weight in lbs. (approx.):	3086	3086
Maximum perm. drawbar load in lbs.:	397	397
<b>Optional</b>		
Golf course kit:	No	Height adjustable roller with scraper
Electromagnetic remote control:	Yes	Yes
Lighting:	Yes	Yes

Descriptions and illustrations are non-binding. We reserve the right to modify the construction and design.



Optimal adaptation to terrain



Easy maintenance



Service flap



Golf course kit

For more information, please contact:

This product is not equipped for use on highways or public roads. Please call our office if you want to buy the appropriate equipment (light kit, SMV vehicle signs, reflectors).

Wiedenmann North America, LLC  
 25A Telfair Place  
 Savannah, GA 31415  
 Tel (912) 790 3004  
 Toll free (866) 790 3004  
 Fax (912) 790 3005  
 E-Mail: office@terraspike.com  
 www.terraspike.com  
 www.wiedenmannusa.com